

# HUBLOT 8 WOOD AIR

## Wood stoves

# CADEL

Certificate model name: HUBLOT 8 WOOD AIR T2



Nominal power	kW	7,5
Reduced power	kW	-
Introduced thermal power (max)	kW	8,8
Nominal water useful power	kW	-
Reduced water useful power	kW	-
Seasonal energy efficiency	ηs [%]	75
Nominal efficiency	%	85
Reduced efficiency	%	-
Heating volume (min-max)	m³	210
Nominal CO at 13% O <sub>2</sub>	%	0,052
Reduced CO at 13% O <sub>2</sub>	%	-
Emissions CO (13% O <sub>2</sub> ) (min-max)	mg/Nm³	650
Emissions OGC (13% O <sub>2</sub> ) (min-max)	mg/Nm³	30
Emissions NOX (13% O <sub>2</sub> ) (min-max)	mg/Nm³	98
Dust content at 13% O <sub>2</sub> (min-max)	mg/Nm³	15
Boiler capacity (H <sub>2</sub> O)	l	-
Hopper capacity	kg	-
Combustible		<b>Legna</b>
Hourly consumption (min-max)	kg/h	1,9
Autonomy (min-max)	h	-
Ignition electrical absorption (max)	W	-
Operating electrical absorption (max)	W	20
Supply and frequency	V - Hz	230 - 50
Chimney flue depression	Pa	12
Mass of smoke (min-max)	g/sec	6,8
Exhaust fumes temperature (max)	°C	174
Net weight	kg	140
Gross weight	kg	150
Exhaust fumes (A)	Ø mm	150
Hole combustion air inlet (B)	Ø mm	80
Ducting outlet (C)	Ø mm	-
Ducting capability up to	m	-

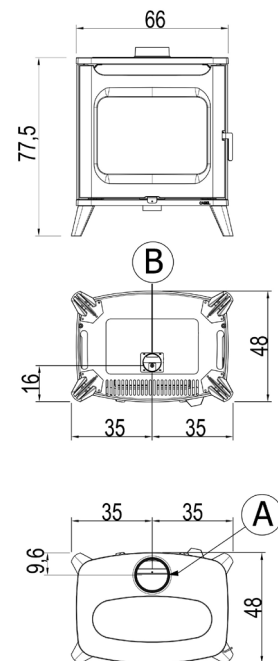

## MATCH

7024036



Black steel

EAN 8053859020974

## PLUS



Cast iron door



Central Top exhaust



Refractory stone inner with 2nd combustion air



Maximum length of the wooden log



Sealed chamber



Anti-smoke valve



Ventilation

## STOVE PACKING

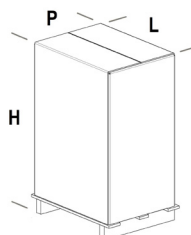

L (cm)	H (cm)	P (cm)
79	94	70

VOLUME (m³)
0,52

## LINING PACKING

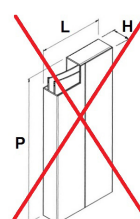

L (cm)	H (cm)	P (cm)

## STOCKING

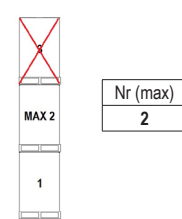

## TRANSPORT

